

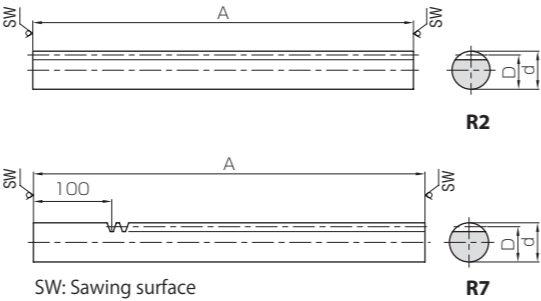

Round Racks



Specifications	
Precision grade	KHK R 001 grade 4
Gear teeth	Standard full depth
Pressure angle	20°
Material	S45C
Heat treatment	—
Tooth hardness	(less than 95HRB)
Surface treatment	Black oxide coating



Catalog No.	Module	Effective no. of teeth	Shape	Total length	Outside dia.	Height to pitch line	Allowable force (N)		Allowable force (kgf)		Weight (kg)
				A	d <sub>h</sub>	D	Bending strength	Surface durability	Bending strength	Surface durability	
<b>SRO1-500</b>	<b>m1</b>	159	R2	505	10	9	800	121	81.6	12.3	0.29
<b>SRO1.5-500</b>	<b>m1.5</b>	105	R2	505	15	13.5	1800	288	184	29.3	0.65
<b>SRO2-500</b>	<b>m2</b>	79	R2	505	20	18	3200	530	326	54.0	1.16
<b>SRO2-1000</b>		159		1010							2.31
<b>SRO2.5-500</b>	<b>m2.5</b>	63	R2	505	25	22.5	5000	848	510	86.5	1.81
<b>SRO2.5-1000</b>		127		1010							3.61
<b>SRO3-500</b>	<b>m3</b>	52	R2	505	30	27	7200	1240	735	127	2.60
<b>SRO3-1000</b>		105		1010							5.20
<b>SRO4-500</b>	<b>m4</b>	39	R2	505	40	36	12800	2270	1310	232	4.62
<b>SRO4-1000</b>		79		1010							9.24
<b>SRO5-1000</b>	<b>m5</b>	63	R2	1010	50	45	20000	3620	2040	369	14.4

Catalog No.	Module	Effective no. of teeth	Shape	Total length	Outside dia.	Height to pitch line	Allowable force (N)		Allowable force (kgf)		Weight (kg)
				A	d <sub>h</sub>	D	Bending strength	Surface durability	Bending strength	Surface durability	
<b>SROS1-500</b>	<b>m1</b>	128	R7	505	10	9	800	121	81.6	12.3	0.29
<b>SROS1.5-500</b>	<b>m1.5</b>	85	R7	505	15	13.5	1800	288	184	29.3	0.66
<b>SROS2-500</b>	<b>m2</b>	64	R7	505	20	18	3200	530	326	54.0	1.17
<b>SROS2.5-500</b>	<b>m2.5</b>	51	R7	505	25	22.5	5000	848	510	86.5	1.83
<b>SROS3-500</b>	<b>m3</b>	42	R7	505	30	27	7200	1240	735	127	2.64

- [Caution on Product Characteristics]
- ① The allowable forces shown in the table are the calculated values according to the assumed usage conditions. Please see Page 190 for more details.
  - ② The backlash of racks differ depending on the size of the mating pinion. Please calculate the backlash from the backlash value of the mating pinion. Also, please refer to the data in the section called 'Backlash of Rack Tooth (Amount of Tooth Thinning)' on Page 193.
  - ③ Tolerance of “d” dimension of SRO6-1000 is h10.
- [Caution on Secondary Operations]
- ① Please read “Caution on Performing Secondary Operations” (Page 194) when performing modifications and/or secondary operations for safety concerns. KHK Quick-Mod Gears, the KHK's system for quick modification of KHK stock gears is also available.
  - ② Please avoid hardening of Round Racks. It causes contortion and deformation, and straightening processes can hardly be applied.

Recommended Mating Pinions



SS Steel Spur Gears

Please see Page 74 for more details.



Stainless Steel Round Racks



Specifications	
Precision grade	KHK R 001 grade 5
Gear teeth	Standard full depth
Pressure angle	20°
Material	SUS303
Heat treatment	—
Tooth hardness	(less than 187HB)

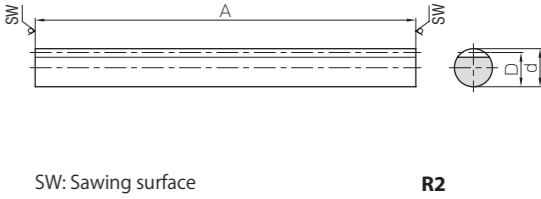

Catalog No.	Module	Effective no. of teeth	Shape	Total length	Outside dia.	Height to pitch line	Allowable force (N)		Allowable force (kgf)		Weight (kg)
				A	d <sub>h</sub>	D	Bending strength	Surface durability	Bending strength	Surface durability	
<b>SURO1-500</b>	<b>m1</b>	159	R2	505	10	9	382	67.9	39.0	6.93	0.29
<b>SURO1.5-500</b>	<b>m1.5</b>	105	R2	505	15	13.5	859	162	87.6	16.5	0.65
<b>SURO2-500</b>	<b>m2</b>	79	R2	505	20	18	1530	298	156	30.4	1.15
<b>SURO2-1000</b>		159		1010							2.30
<b>SURO2.5-500</b>	<b>m2.5</b>	63	R2	505	25	22.5	2390	477	243	48.7	1.79
<b>SURO2.5-1000</b>		127		1010							3.59
<b>SURO3-500</b>	<b>m3</b>	52	R2	505	30	27	3440	700	351	71.4	2.58
<b>SURO3-1000</b>		105		1010							5.17

- [Caution on Product Characteristics]
- ① The allowable forces shown in the table are the calculated values according to the assumed usage conditions. Please see Page 190 for more details.
  - ② The backlash of racks differ depending on the size of the mating pinion. Please calculate the backlash from the backlash value of the mating pinion. Also, please refer to the data in the section called 'Backlash of Rack Tooth (Amount of Tooth Thinning)' on Page 193.
- [Caution on Secondary Operations]
- ① Please read “Caution on Performing Secondary Operations” (Page 194) when performing modifications and/or secondary operations for safety concerns. KHK Quick-Mod Gears, the KHK's system for quick modification of KHK stock gears is also available.

Recommended Mating Pinions



SUS・SUSA Stainless Steel Spur Gears

Please see Page 126 for more details.